



**US Army Corps  
of Engineers®**

# PUBLIC NOTICE

Applicant:  
Bryant Killen  
Tensas Parish Port Harbor and  
Terminal District

Published: July 3, 2025  
Expires: July 24, 2025

---

**Vicksburg District**  
**Permit Application No. MVK-2024-00397**

TO WHOM IT MAY CONCERN: The Vicksburg District of the U.S. Army Corps of Engineers (Corps) has received an application for a Department of the Army permit pursuant to Section 404 of the Clean Water Act (33 U.S.C. §1344) **and/or** Section 10 of the Rivers and Harbors Act of 1899 (33 U.S.C. §403). The purpose of this public notice is to solicit comments from the public regarding the work described below:

**APPLICANT:** Bryant Killen  
Tensas Parish Port Harbor and Terminal District  
112 Front Street  
Vidalia, Louisiana 71373

**AGENT:** Keith Capdepon  
Bryant Hammett & Associates, LLC  
6885 Highway 84 West  
Ferriday, Louisiana 71334

**WATERWAY AND LOCATION:** The project would affect waters of the United States (WOTUS) associated with the Mississippi River. The project/review area is located at the end of an unnamed road off LA 604, on the banks of the Mississippi River in Section 6, Township 11 North, Range 12 East; at Latitude 31.937527 and Longitude - 91.199043; in Tensas Parish, Louisiana.

**EXISTING CONDITIONS:** The proposed project area encompasses approximately 30.7 acres of land directly adjacent to the Mississippi River. The project site is approximately 2 miles northeast of the town of St. Joseph, in Tensas Parish, Louisiana and is located approximately 0.5 miles down an unnamed road off LA 604. The proposed site is located in HUC 08060100 (Lower Mississippi Region). There are approximately 0.6-acres of Section 10/404 other waters present within the project boundary. In addition, 17.97-acres of Section 10/404 Palustrine Forested Wetlands are present. The remainder of the site is primarily forested uplands.

The dominant vegetative community within the forested wetland area consists of Sugarberry, Black Willow, and American Elm. Soil within the project site is dominated by Sharkey, Newellton, and Tunica Soils with a hydric soil rating of 100%.

**PROJECT PURPOSE:** To construct a grain storage facility and barge terminal to enable more efficient transportation of grain commodities by the local farming community. This proposed facility will replace the Bunge Elevator facility located upstream of this site.

**Basic:** Industrial Development

**Overall:** To construct a grain storage facility and barge terminal on the Mississippi River in Tensas Parish, Louisiana.

**PROPOSED WORK:** To facilitate the development of the grain storage facility which includes an access and turnaround area, a truck grain dump, grain storage tanks, and a grain conveyor with a barge loading facility, 2.04 acres of Section 10/404 Palustrine Forested wetland (WOTUS) are proposed to be permanently impacted. No additional, subsequent fill of WOTUS is proposed in this application. There will be Section 10 activities within the OHWM of the Mississippi River to install steel piles and mooring dolphins for the barge loading facility. The remaining WOTUS present within the project area would be avoided.

**AVOIDANCE AND MINIMIZATION:** The applicant has provided the following information in support of efforts to avoid and/or minimize impacts to the aquatic environment: Based on a Preliminary Wetlands Determination dated July 14, 2020, the project site was placed in an area that would minimize impacts to wetlands. The grain conveyor supported by piles will cross over only a small part of a wetland area.

**COMPENSATORY MITIGATION:** The applicant offered the following compensatory mitigation to offset unavoidable functional loss to the aquatic environment: The required mitigation would be purchased from an USACE approved mitigation bank located within the same watershed as the impacts prior to the commencement of the planned project.

**CULTURAL RESOURCES:**

The Corps is evaluating the undertaking for effects to historic properties as required under Section 106 of the National Historic Preservation Act. This public notice serves to inform the public of the proposed undertaking and invites comments including those from local, State, and Federal government Agencies with respect to historic resources. Our final determination relative to historic resource impacts may be subject to additional coordination with the State Historic Preservation Officer, federally recognized tribes and other interested parties.

**ENDANGERED SPECIES:** The Corps has performed an initial review of the application, the U.S. Fish and Wildlife Service (USFWS) Information for Planning and Consultation (IPaC), to determine if any threatened, endangered, proposed, or candidate species, as well as the proposed and final designated critical habitat may occur in the vicinity of the proposed project. Based on this initial review, the Corps has made a preliminary determination that the proposed project may affect species and critical habitat listed

below. No other ESA-listed species or critical habitat will be affected by the proposed action.

Pallid Sturgeon (*Scaphirhynchus albus*) - May affect  
Fat Pocketbook (*Potamilus capax*) - May affect

Pursuant to Section 7 ESA, any required consultation with the Service(s) will be conducted in accordance with 50 CFR part 402. The Corps is the lead Federal agency for ESA consultation for the proposed action. Any required consultation will be completed by the Corps.

This notice serves as request to the U.S. Fish and Wildlife Service for any additional information on whether any listed or proposed to be listed endangered or threatened species or critical habitat may be present in the area which would be affected by the proposed activity.

**NAVIGATION:** The proposed structure or activity is located in the vicinity of the Mississippi River, a federal navigation channel. Coordination with the USACE Navigation office has been initiated to ensure that the proposed work will not impede navigation.

**SECTION 408:** The applicant will not require permission under Section 14 of the Rivers and Harbors Act of 1899 (33 USC 408) because the activity, in whole or in part, would not alter, occupy, or use a Corps Civil Works project.

**WATER QUALITY CERTIFICATION:** Water Quality Certification may be required from the Louisiana Department of Environmental Quality (LDEQ)

**NOTE:** This public notice is being issued based on information furnished by the applicant. This information has not been verified or evaluated to ensure compliance with laws and regulation governing the regulatory program. The geographic extent of aquatic resources within the proposed project area that either are, or are presumed to be, within the Corps jurisdiction has not been verified by Corps personnel.

**EVALUATION:** The decision whether to issue a permit will be based on an evaluation of the probable impact including cumulative impacts of the proposed activity on the public interest. That decision will reflect the national concern for both protection and utilization of important resources. The benefits, which reasonably may be expected to accrue from the proposal, must be balanced against its reasonably foreseeable detriments. All factors which may be relevant to the proposal will be considered including cumulative impacts thereof; among these are conservation, economics, esthetics, general environmental concerns, wetlands, historical properties, fish and wildlife values, flood hazards, floodplain values, land use, navigation, shoreline erosion and accretion, recreation, water supply and conservation, water quality, energy needs, safety, food, and fiber production, mineral needs, considerations of property ownership, and in general, the needs and welfare of the people. Evaluation of the impact of the

activity on the public interest will also include application of the guidelines promulgated by the Administrator, EPA, under authority of Section 404(b) of the Clean Water Act or the criteria established under authority of Section 102(a) of the Marine Protection Research and Sanctuaries Act of 1972. A permit will be granted unless its issuance is found to be contrary to the public interest.

**COMMENTS:** The Corps is soliciting comments from the public; Federal, State, and local agencies and officials; Indian Tribes; and other Interested parties in order to consider and evaluate the impacts of this proposed activity. Any comments received will be considered by the Corps to determine whether to issue, modify, condition, or deny a permit for this proposal. To make this determination, comments are used to assess impacts to endangered species, historic properties, water quality, general environmental effects, and the other public interest factors listed above. Comments are used in the preparation of an Environmental Assessment (EA) and/or an Environmental Impact Statement pursuant to the National Environmental Policy Act (NEPA). Comments are also used to determine the need for a public hearing and to determine the overall public interest of the proposed activity.

The Vicksburg District will receive written comments on the proposed work, as outlined above, until July 24, 2025. Comments should be submitted electronically via the Regulatory Request System (RRS) at <https://rrs.usace.army.mil/rrs> or to William McFarland at William.J.Mcfarland@usace.army.mil. Alternatively, you may submit comments in writing to Mr. McFarland, U.S. Army Corps of Engineers, Vicksburg District, Attention: William , 4155 East Clay Street Vicksburg, Mississippi 39183-3435. Please refer to the permit application number in your comments.

Any person may request, in writing, within the comment period specified in this notice, that a public hearing be held to consider the application. Requests for public hearings shall state, with particularity, the reasons for holding a public hearing. Requests for a public hearing will be granted, unless the District Engineer determines that the issues raised are insubstantial or there is otherwise no valid interest to be served by a hearing.

Notification of Final Permit Actions: Each month, the final permit actions from the preceding month are published on the Vicksburg District Regulatory web page. To access this information, you may follow the link from the Regulatory web page, <http://www.mvk.usace.army.mil/Missions/Regulatory.aspx>.



**Molly Connerton**  
**Chief (Acting), Arkansas/Louisiana**  
**Branch**  
**Regulatory Division**





SHEET

1

TENSAS PARISH PORT, HARBOR  
AND TERMINAL DISTRICT  
PRELIMINARY LAYOUT

DATE:  
5/2025

DRAWN BY:  
FES

DESIGNED BY:

CHECKED BY:  
CAC,JF

BRYANT HAMMETT  
& ASSOCIATES, LLC

CIVIL ENGINEERING & LAND SURVEYING  
6885 HWY 84 WEST - FERRIDAY, LA 71334  
(318) 757-6576

Google

Imagery ©2024 Airbus, Maxar Technologies

72" DIA. MOORING DOLPHIN  
(END DOLPHIN)

60" DIA. INTERMEDIATE MOORING  
DOLPHIN, TYP. (10 EACH)

BARGE LOADER

54" DIA. STEEL PILE, TYP. (4  
Each)

30" DIA. STEEL PILE (4 TOTAL)  
(2 EACH/LOCATION)

72" DIA. MOORING DOLPHIN  
(END DOLPHIN)

5/29/25 REVISION - ADDED: DESCRIPTIONS, PILES, &  
DIMENSIONS FOR GRAIN STORAGE TANKS, LOADING  
CONVEYOR, BARGE LOADER & MOORING DOLPHINS

NO.

DESCRIPTION

BY

FILE NO.: 6830



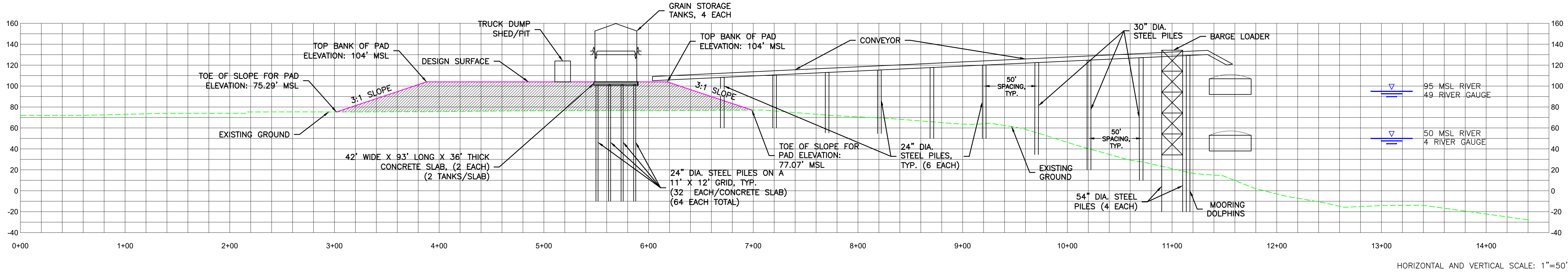

PROFILE A

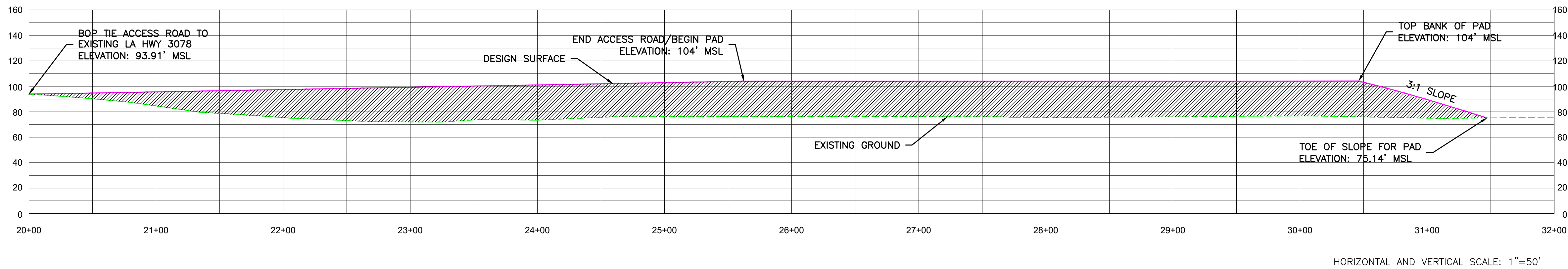

PROFILE B

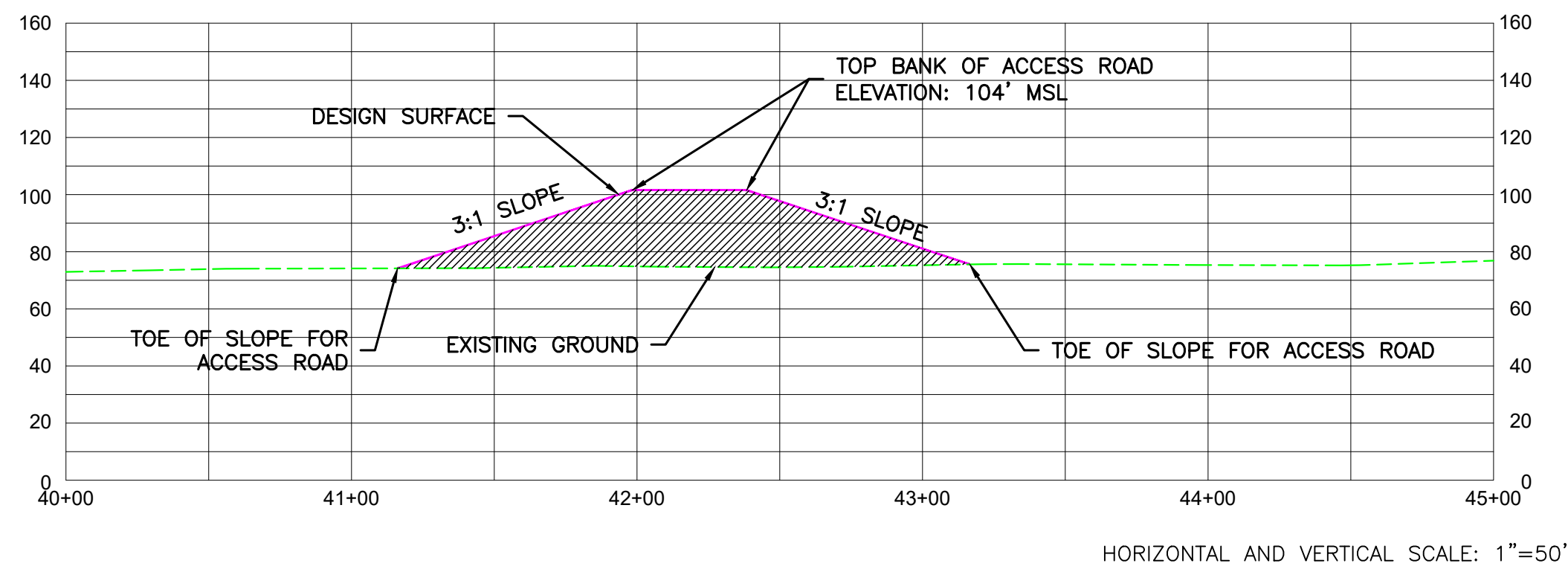

PROFILE C

SHEET2

TENSAS PARISH PORT, HARBOR AND TERMINAL DISTRICT  
PROFILE SHEET

DATE:  
5/2025

DRAWN BY:  
FES

DESIGNED BY:

CHECKED BY:  
CAC, Jr.

BRYANT HAMMETT & ASSOCIATES, LLC

CIVIL ENGINEERING & LAND SURVEYING

6885 HWY 84 WEST — FERRIDAY, LA 71334

(318) 757-6576

5/29/25 REVISION — ADDED: DESCRIPTIONS, PILES, & DIMENSIONS FOR GRAIN STORAGE TANKS, LOADING CONVEYOR, BARGE LOADER & MOORING DOLPHINS

1

NO.

BY:

DESCRIPTION

REVISIONS

FILE NO.: 6830





SCALE: 1"=100'

NOTE: ATTACHED AERIAL BACKGROUND SITE MAP FROM MVK-2020-255 US COE JURISDICTIONAL DETERMINATION DATED JULY 14, 2020

APPROXIMATE WETLAND IMPACT		
AREA #	SQFT	ACRE
1	74,100	1.70
2	1,360	0.03
3	13,500	0.31
TOTAL	88,960	2.04

DATE: 11/2024  
DRAWN BY: FES  
DESIGNED BY:  
CHECKED BY: CAC, Jr.

**TENSAS PARISH PORT, HARBOR AND TERMINAL DISTRICT WETLANDS MAP**  
(BASED ON PREVIOUS COE DETERMINATION)

**BRYANT HAMMETT & ASSOCIATES, LLC**  
CIVIL ENGINEERING & LAND SURVEYING  
6885 HWY 84 WEST - FERRIDAY, LA 71334  
(318) 757-6576



NO.	DESCRIPTION	BY
1	6/5/25 REVISION - ADDED: PILES, ACCESS ROAD, TRUCK TURN AROUND, GRAIN STORAGE TANKS, LOADING CONVEYOR, BARGE LOADER & MOORING DOLPHINS	CAC, Jr.

FILE NO.: 6830